

MOD.

V9-4E 9242600  
 V9-8E 9242700

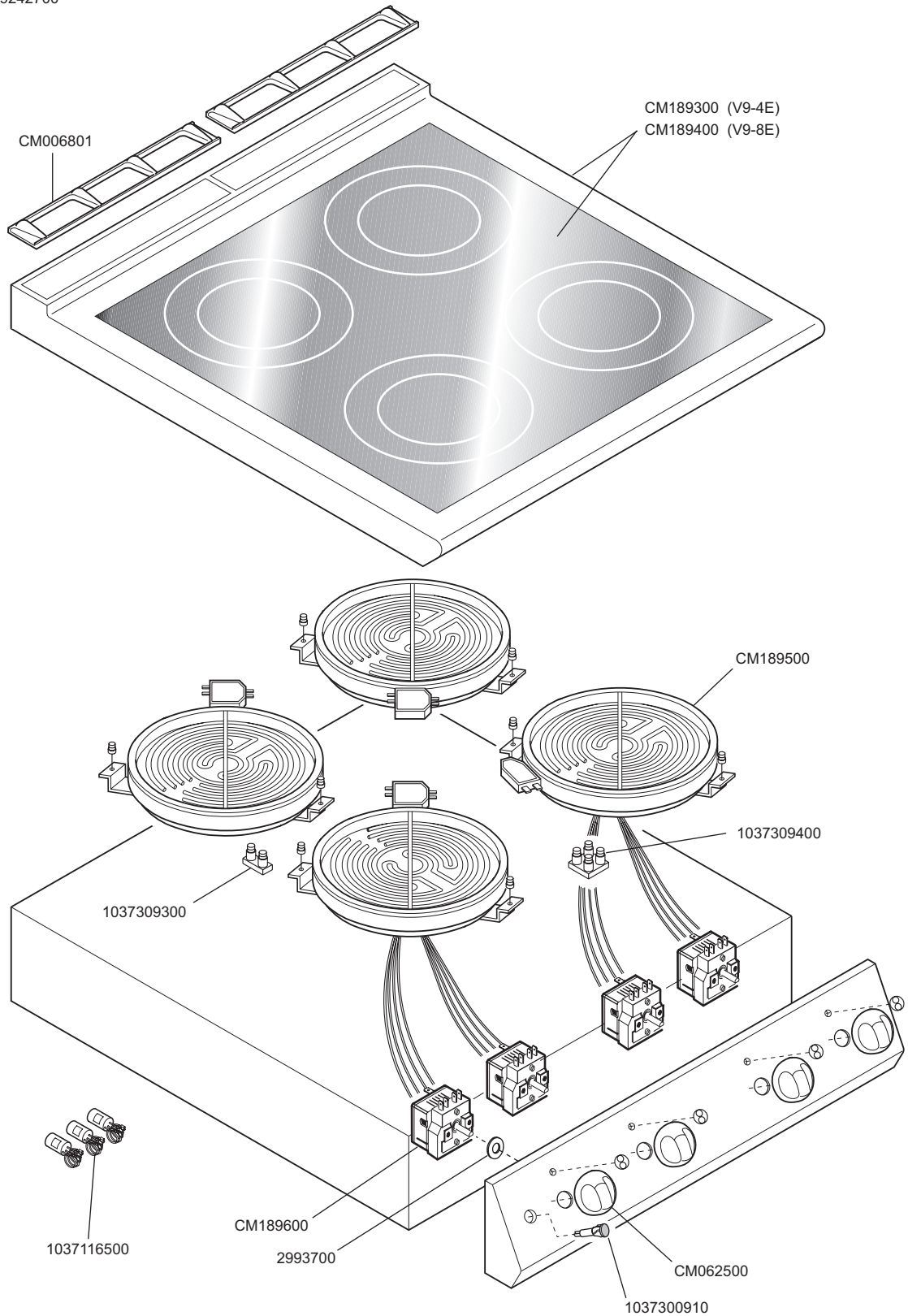

|                         |             |                                |                             |         |             |
|-------------------------|-------------|--------------------------------|-----------------------------|---------|-------------|
| ELABORATO:              | APPROVATO:  | GRUPPO:                        | DENOMINAZIONE:              |         |             |
| <i>art</i> LINEA s.p.a. |             | Serie 90                       | Impianto elettrico e mobile |         |             |
| DATA:                   | DATA:       | PARTICOLARE:                   | REV. N.                     | DEL     | DISEGNO N.  |
| 10 Feb 1999             | 10 Feb 1999 | Disegno esploso<br>per ricambi | ▼                           | ▼       | ▼           |
| SOST. DIS.              |             | CE                             | Z 0 0                       | 9 9 0 2 | 3 . P . 0 7 |

**MOD.**

V9-4E 9242600  
 V9-8E 9242700

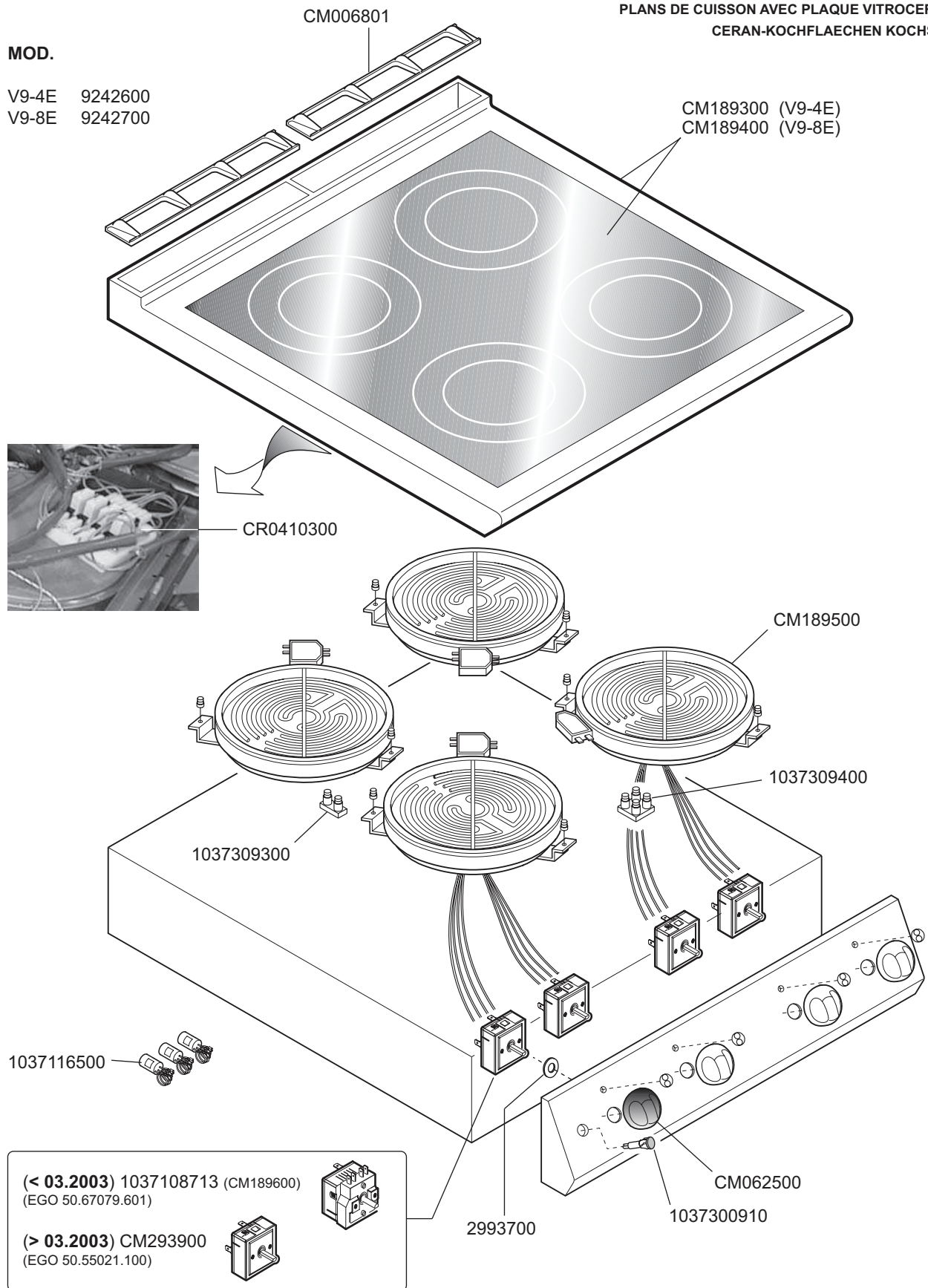

|   |                 |             |                             |                             |      |            |
|---|-----------------|-------------|-----------------------------|-----------------------------|------|------------|
| <br>MARENO INDUSTRIE ALI spa<br>Mareno di Piave (TV) | ELABORATO:      | APPROVATO:  | GRUPPO:                     | DENOMINAZIONE:              |      |            |
|   | G.Z.            |             | Serie 90                    | Impianto elettrico e mobile |      |            |
|   | DATA:           | DATA:       | PARTICOLARE:                | REV. N.                     | DEL  | DISEGNO N. |
|   | 10 Feb 1999     | 10 Feb 1999 | Disegno esploso per ricambi | ▼                           | ▼    | ▼          |
| SOST. DIS.  | Z00 9902 3.P.07 |             | CE                          | Z01                         | 0203 | 3.P.07     |

MOD.

V9-4E 9242600  
 V9-8E 9242700

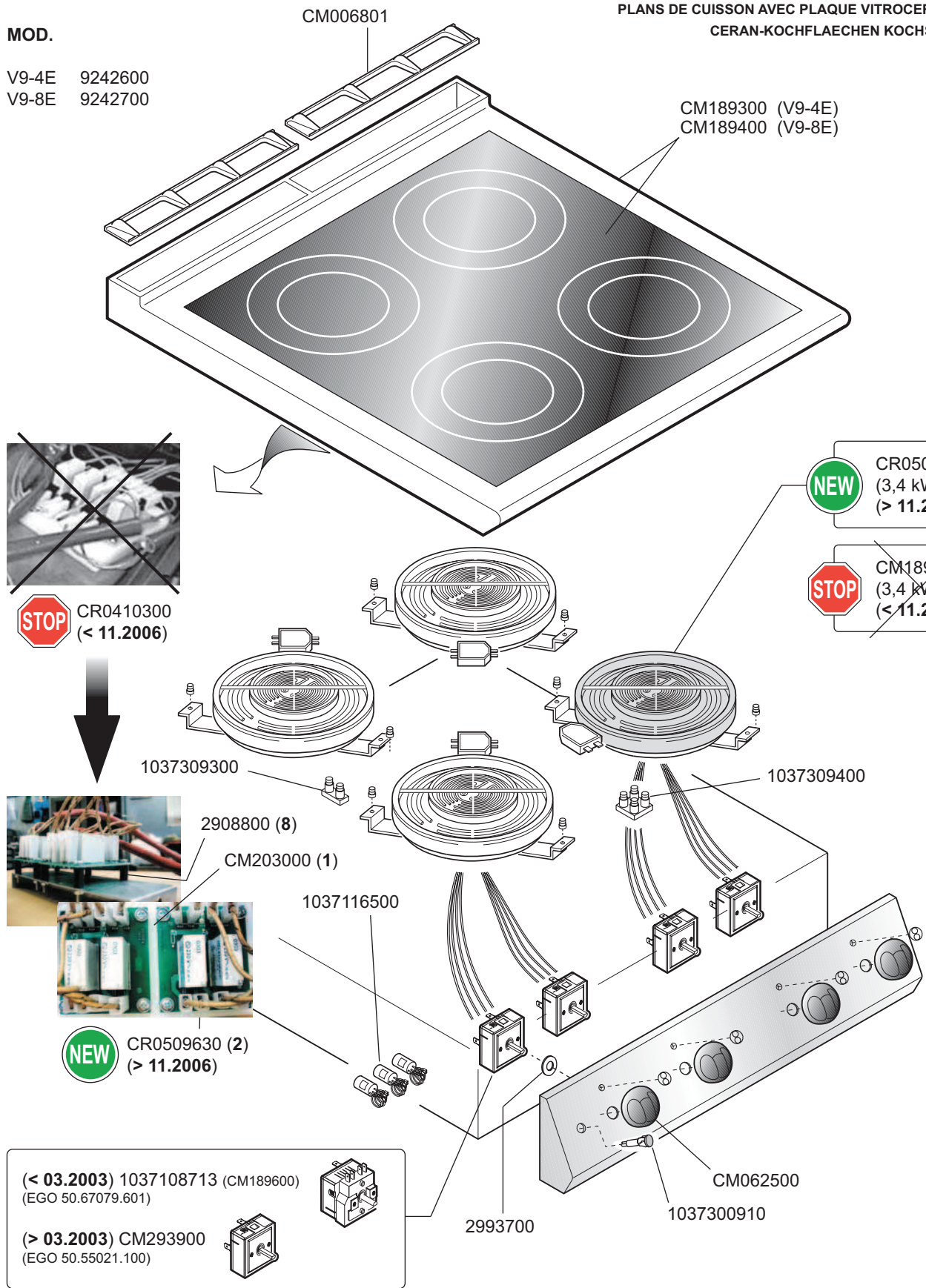

|   |                 |             |                             |                             |      |            |
|---|-----------------|-------------|-----------------------------|-----------------------------|------|------------|
| <br>MARENO INDUSTRIE ALI spa<br>Mareno di Piave (TV) | ELABORATO:      | APPROVATO:  | GRUPPO:                     | DENOMINAZIONE:              |      |            |
|   | G.Z.            |             | Serie 90                    | Impianto elettrico e mobile |      |            |
|   | DATA:           | DATA:       | PARTICOLARE:                | REV. N.                     | DEL  | DISEGNO N. |
|   | 10 Feb 1999     | 10 Feb 1999 | Disegno esploso per ricambi | ▼                           | ▼    | ▼          |
| SOST. DIS.  | Z01 0203 3.P.07 |             | CE                          | Z01                         | 1106 | 3.P.07     |

MOD.

V9-4E 9242600  
 V9-8E 9242700

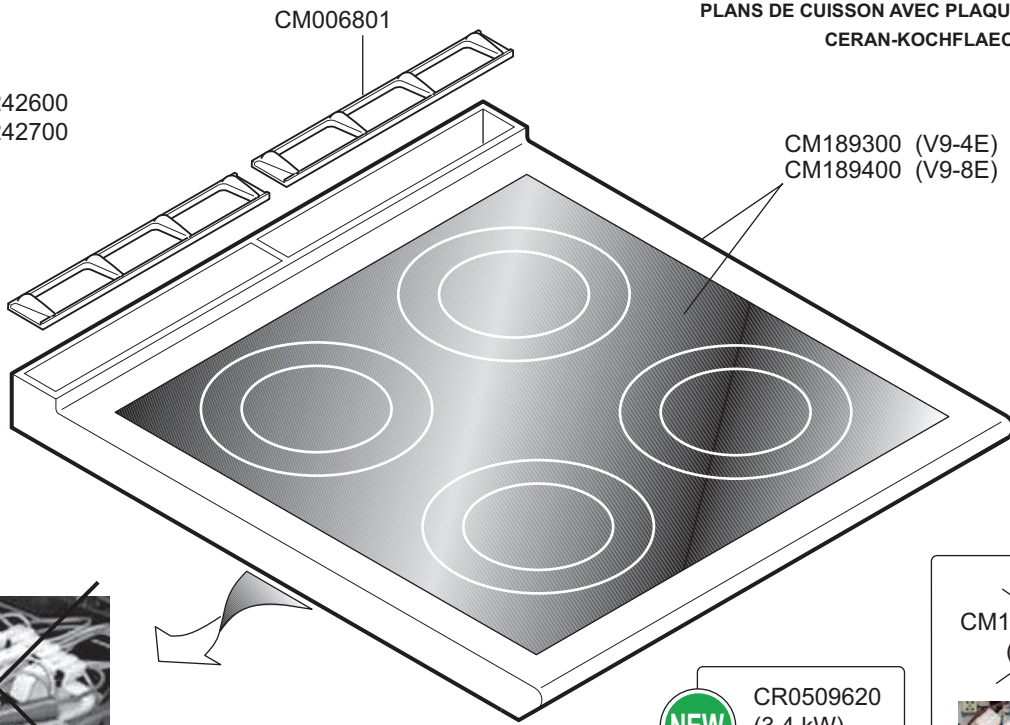

**STOP** CR0410300  
 (< 11.2006)



**NEW** CR0509630R  
 (> 11.2006)

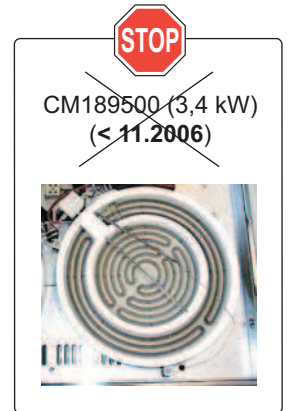

**STOP** CM189500 (3,4 kW)  
 (< 11.2006)

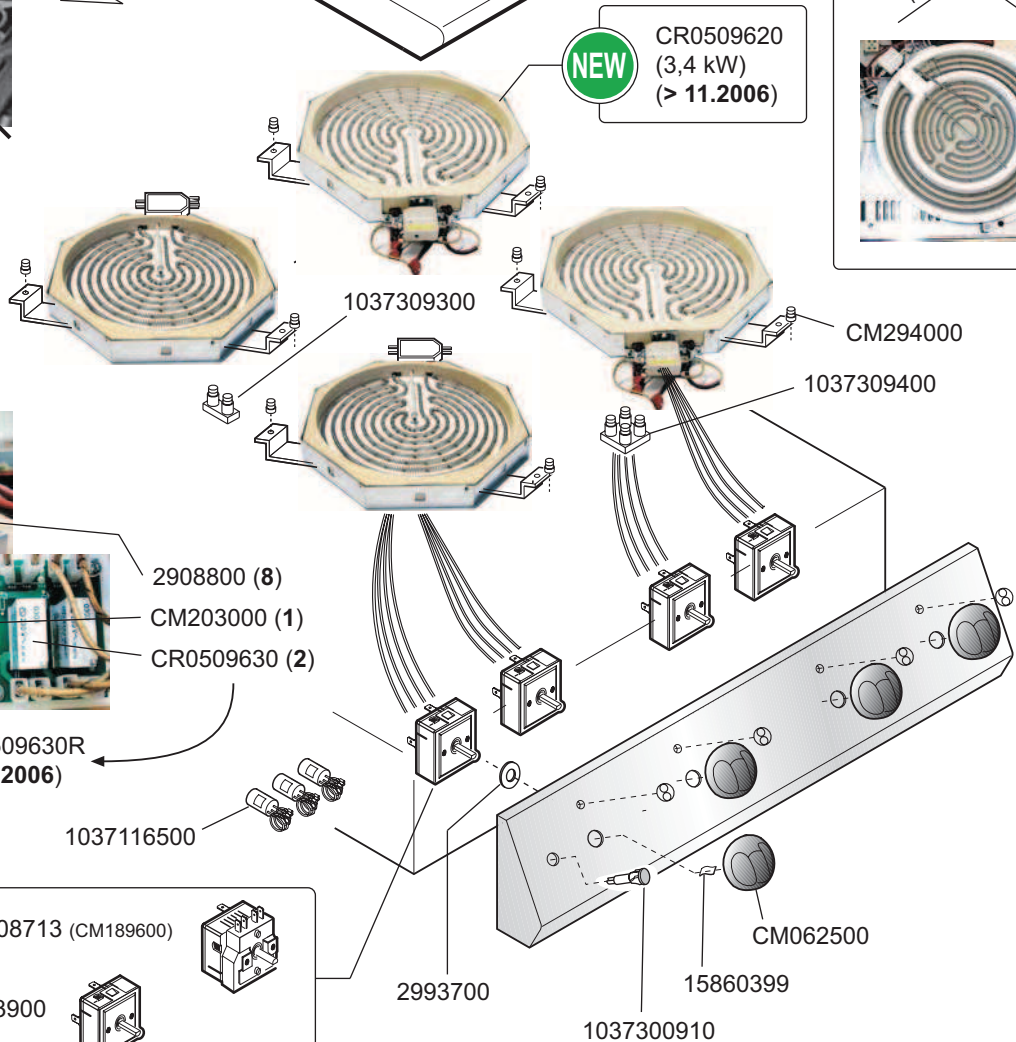

(< 03.2003) 1037108713 (CM189600)  
 (EGO 50.67079.601)

(> 03.2003) CM293900  
 (EGO 50.55021.100)

|   |                 |             |                             |                             |      |            |
|---|-----------------|-------------|-----------------------------|-----------------------------|------|------------|
| <p>MARENO INDUSTRIE ALI spa<br/>                 Mareno di Piave (TV)</p> | ELABORATO:      | APPROVATO:  | GRUPPO:                     | DENOMINAZIONE:              |      |            |
|   | G.Z.            |             | Serie 90                    | Impianto elettrico e mobile |      |            |
|   | DATA:           | DATA:       | PARTICOLARE:                | REV. N.                     | DEL  | DISEGNO N. |
|   | 10 Feb 1999     | 10 Feb 1999 | Disegno esploso per ricambi | ▼                           | ▼    | ▼          |
| SOST. DIS.  | Z01 0203 3.P.07 |             | CE                          | Z01                         | 1106 | 3.P.07     |