

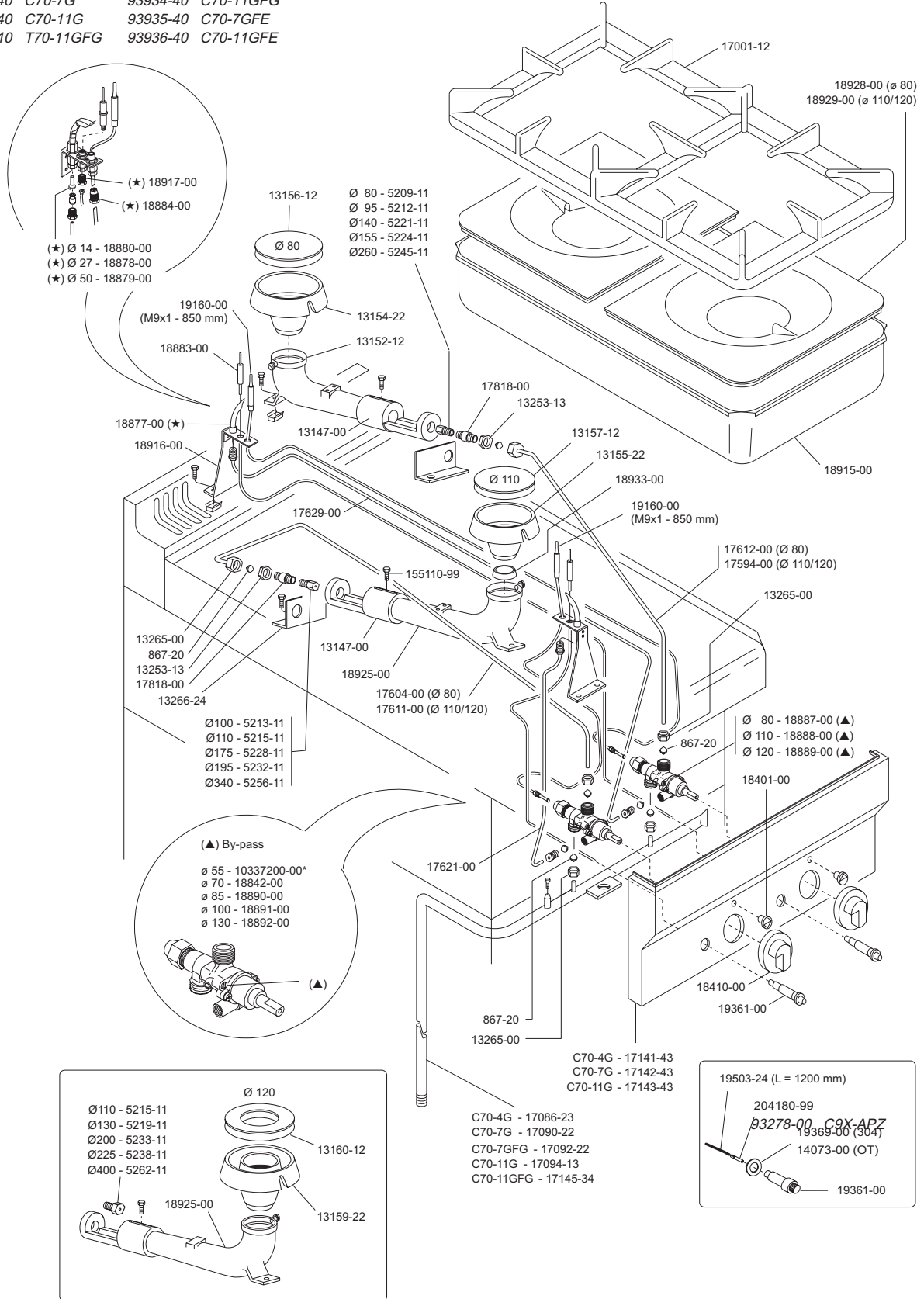



CUCINE A GAS  
 GAS HEATED RANGES  
 CUISINIÈRES A GAZ  
 ALLGASHERDE  
 COCINAS A GAS

93930-40 C70-4G      93933-40 C70-7GFG  
 93931-40 C70-7G      93934-40 C70-11GFG  
 93932-40 C70-11G      93935-40 C70-7GFE  
 93963-10 T70-11GFG    93936-40 C70-11GFE



|  |                       |            |                              |                         |     |            |
|--|-----------------------|------------|------------------------------|-------------------------|-----|------------|
| <br><b>MARENO INDUSTRIE ALI spa</b><br>Mareno di Piave (TV) | ELABORATO:            | APPROVATO: | GRUPPO:                      | DENOMINAZIONE:          |     |            |
|  | <i>Plm</i>            |            | Serie 700                    | Impianto a gas e mobile |     |            |
|  | DATA:                 | DATA:      | PARTICOLARE:                 | REV. N.                 | DEL | DISEGNO N. |
|  | 10 Nov 96             | 10 Nov 96  | Disegno esploso per ricambi  | ▼                       | ▼   | ▼          |
| SOST. DIS.   | Z02 - 9611.3.7.12.C7G |            | <b>Z02 - 9611.3.7.12.C7G</b> |                         |     |            |



**MOD.**  
 C70-4G 9393040  
 C70-7G 9393140  
 C70-11G 9393240  
 C70-7GFG 9393340  
 C70-11GFG 9393440  
 C70-7GFE 9393540  
 C70-11GFE 9393640  
 T70-11GFG 9396310

**CUCINE A GAS - FUOCHI APERTI**  
**GAS HEATED RANGES - OPEN BURNER**  
**CUISINIÈRES A GAZ - FEUX VIFS**  
**ALLGASHERDE - OFFENE KOCHSTELLEN**

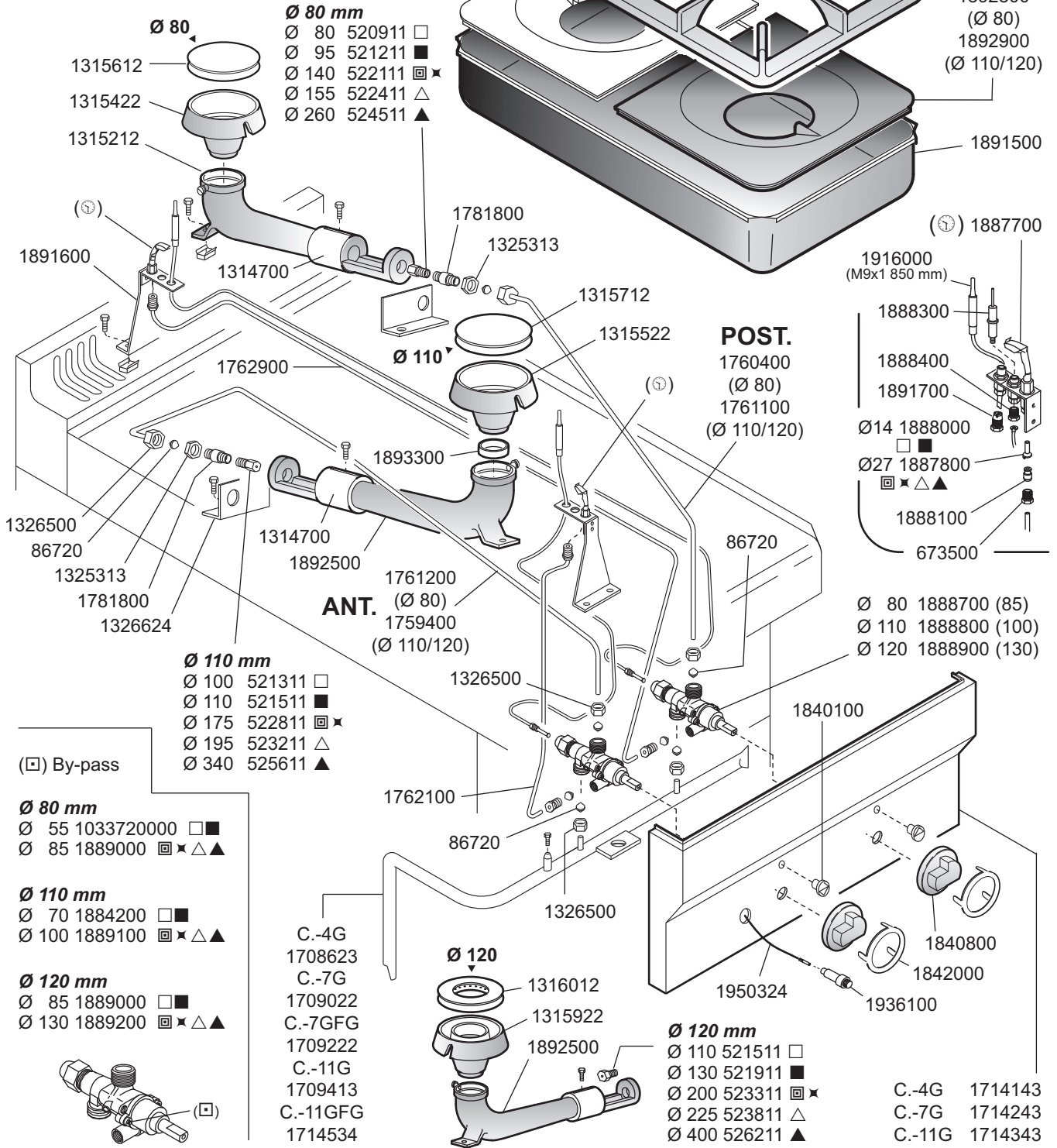

**ID GAS:** □ G30/50 ■ G30/29 □ G20/20 ✕ G25/25 △ G25/20 ▲ G110/8 □ G120/8 ✕ G140/8

|  |                     |             |                             |                       |      |            |
|--|---------------------|-------------|-----------------------------|-----------------------|------|------------|
| <br>MARENO INDUSTRIE ALI spa <sup>sa</sup><br>Mareno di Piave (TV) | ELABORATO:          | APPROVATO:  | GRUPPO:                     | DENOMINAZIONE:        |      |            |
|  | G.Z.                |             | Serie 700                   | Impianto gas e mobile |      |            |
|  | DATA:               | DATA:       | PARTICOLARE:                | REV. N.               | DEL  | DISEGNO N. |
|  | 24 Nov 1996         | 24 Nov 1996 | Disegno esploso per ricambi | Z03                   | 0902 | 3.7.12     |
| SOST. DIS.   | Z02 9611 3.7.12.C7G |             |                             |                       |      |            |