

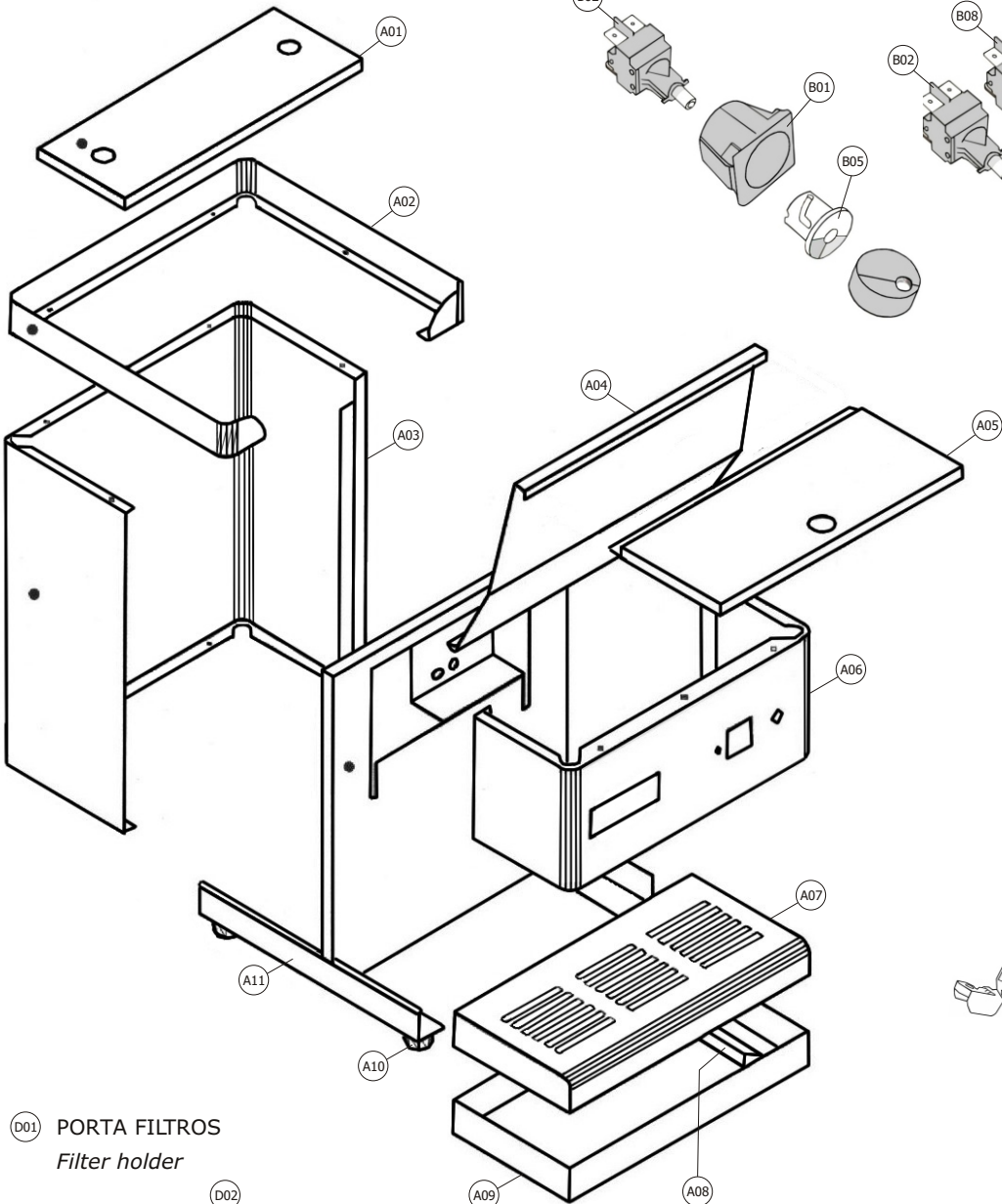

- > **GRUPOS** 1
GROUPS
- > **POTÊNCIA** 1250w
POWER
- > **DIMENSÕES (LPH)** 275x280x355mm
DIMENSIONS
- > **PESO LÍQUIDO** 11 Kg
NET WEIGHT
- > **PESO BRUTO** 12 Kg
GROSS WEIGHT
- > **DIMENSÕES DA EMBALAGEM (LPH)** 330X295X400mm
PACKAGE DIMENSIONS

BLINDAGEM, PAÍNEIS, CHASSI E PÉS
Shields, Panels, Acrylics, Chassi and Feet



INTERRUPTORES (Modelo corrente)
Switches

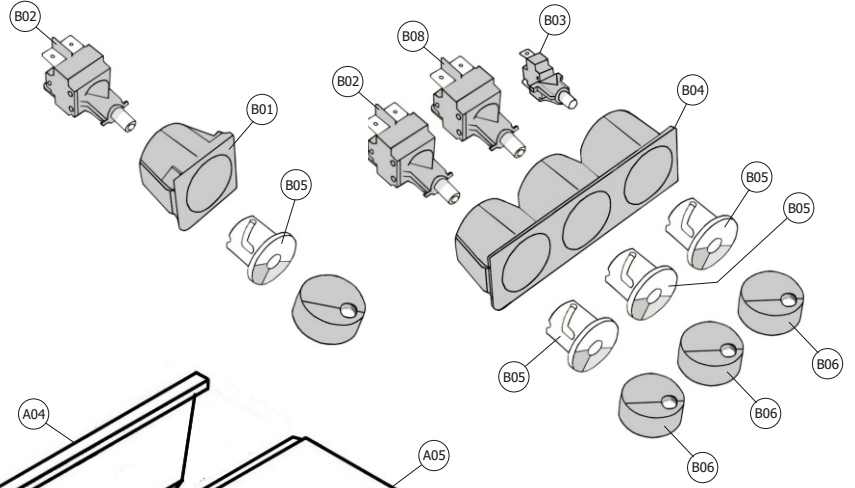

INTERRUPTORES (Modelo antigo)
Switches (Old model)

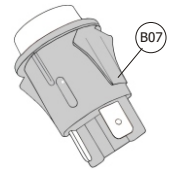

CABO DE ALIMENTAÇÃO
Cable

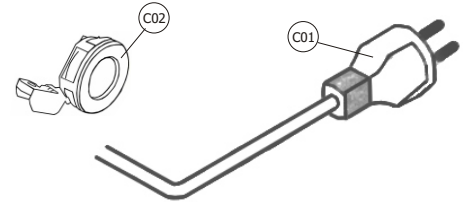

D01 PORTA FILTROS
Filter holder

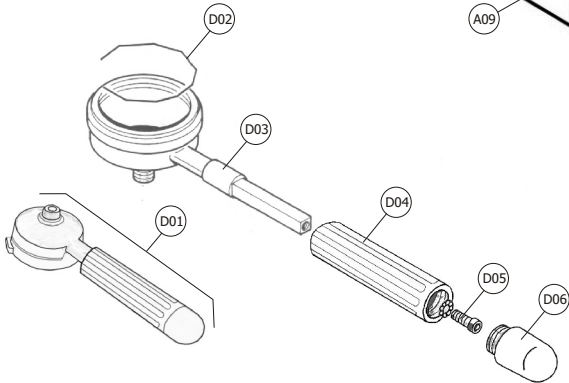

TORNEIRA ÁGUA QUENTE / VAPOR
Tap Hot water / Steam

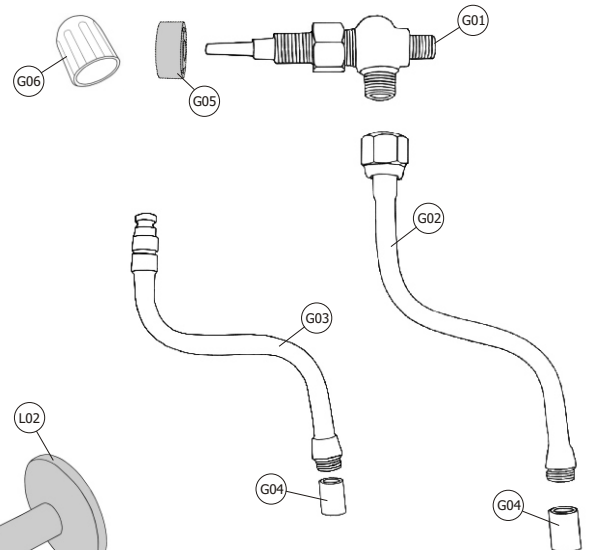

FILTROS
Filter

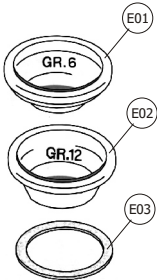

COLHER E CALCADOR
Spoon and coffee tamp

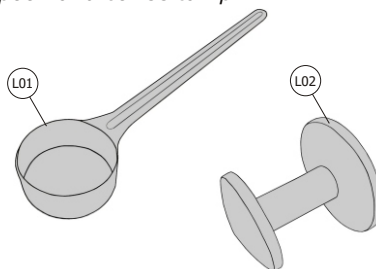

F01 DISTRIBUIDORES
Way spout



CONJUNTO MECANICO (Modelo corrente)
Mechanic ass. (New model)

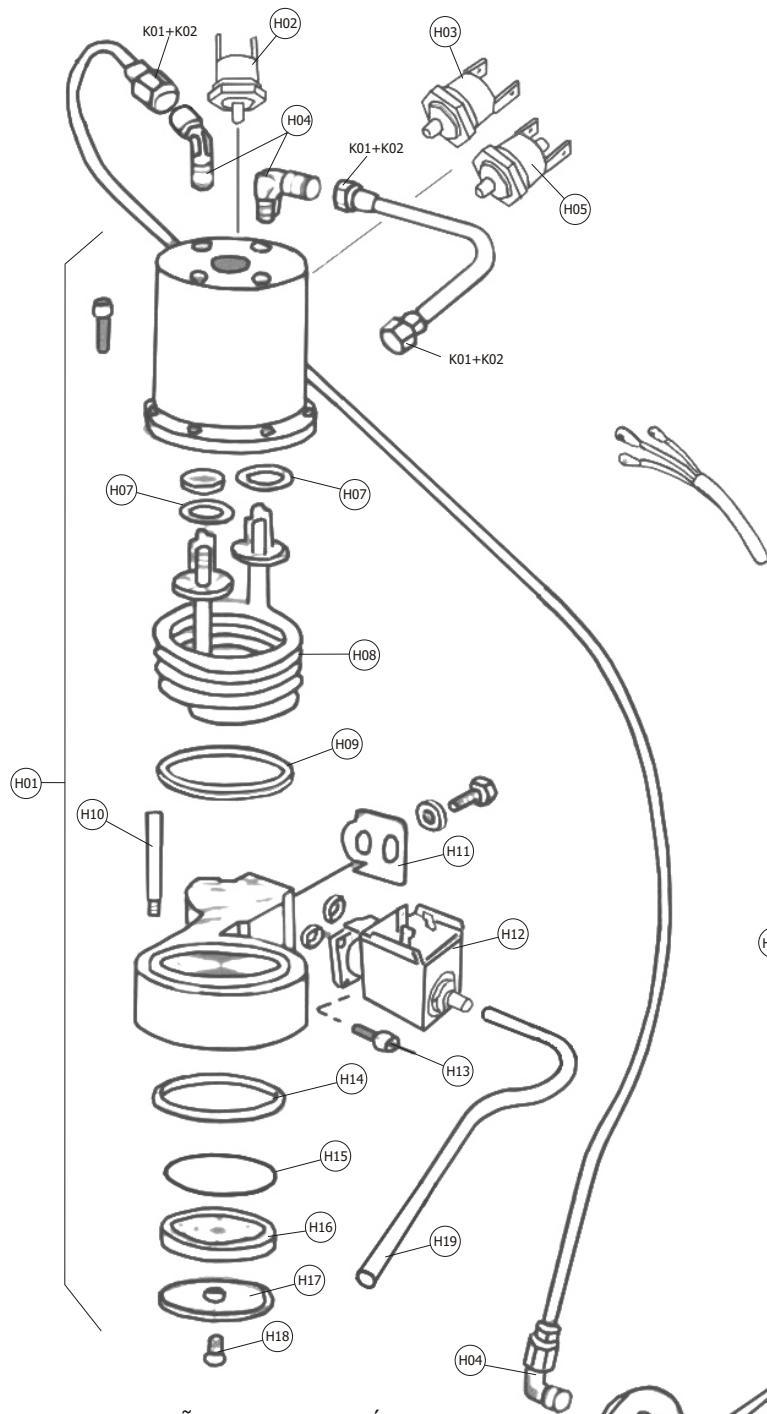

CONJUNTO MECANICO (Modelo antigo)
Mechanic ass. (Old model)

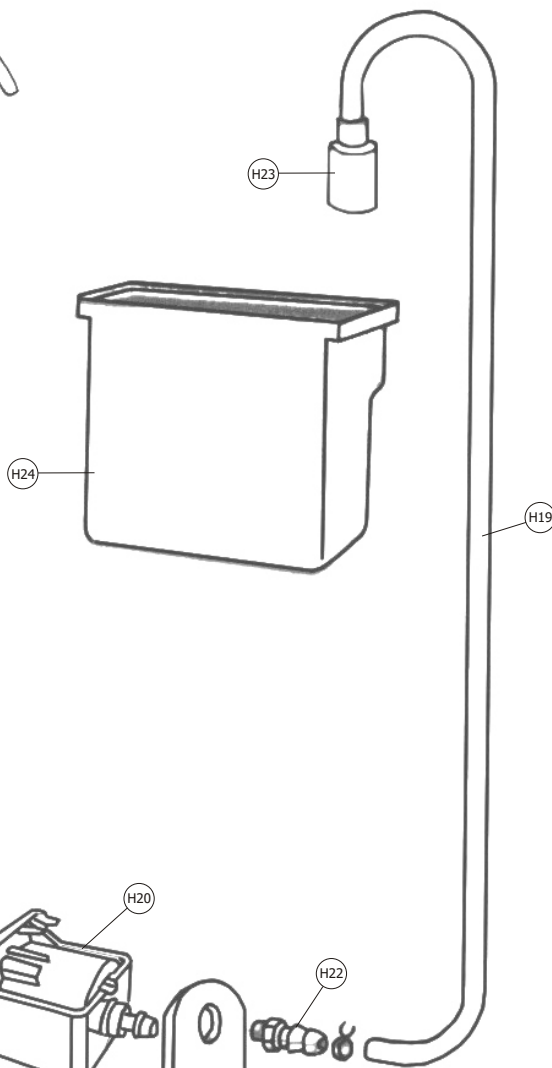
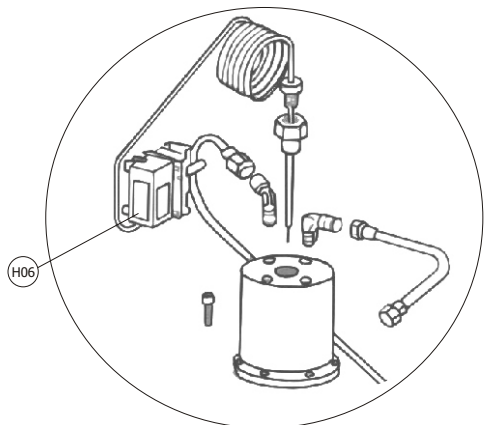

CONJUNTO DE DETECÇÃO DO NÍVEL DE ÁGUA
Water level detector assembly

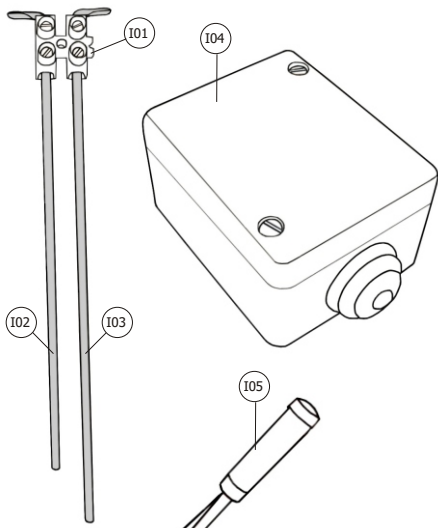

PORCAS E BICONES
Nuts and smashing nut

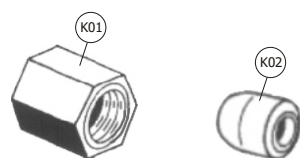

A01	>	7.0.001.0048	TAMPA POSTERIOR Front cover	H10	>	5.0.000.0927	O'ring for group body TUBO DO NÍVEL Level Tube
A02	>	7.0.001.0030	ARO SUPERIOR Upper ring	H11	>	5.0.000.0278	JUNTA DO GRUPO Group gasket
A03	>	7.0.001.0033	BLINDAGEM Shields	H12	>	5.0.000.0127	ELECTROVÁLVULA 220V Electrovalve 220V
A04	>	7.0.001.0039	SEPARADOR INTERIOR Inner deviser		>	5.0.000.0129	ELECTROVÁLVULA 110V Electrovalve 110V
A05	>	7.0.001.0036	TAMPA ANTERIOR Rear cover	H13	>	5.0.000.0575	PARAFUSO FIX. BASE MAG. VALV. M4X12 Screw M4X12
A06	>	7.0.001.0021	PAINEL COMANDO CONJ. Control panel assembly	H14	>	5.0.000.0283	JUNTA PORTA FILTRO FACETADA Filter holder gasket
A07	>	7.0.001.0045	GRELHA TABULEIRO INFERIOR. Grid of the lower tray	H15	>	5.0.000.0526	ORING PORTA CRIVO VITON Viton o'ring for sieve holder
A08	>	7.0.001.0051	PROTEÇÃO ANTI-SALPICOS Spilling protection	H16	>	5.0.000.0650	PORTA CRIVO Sieve holder
A09	>	7.0.001.0042	TABULEIRO INFERIOR Lower tray	H17	>	5.0.000.0063	CRIVO DO GRUPO Group sieve
A10	>	4.0.000.0650	PÉS SJ-5514 PRETO Black feet SJ-5514	H18	>	5.0.000.0585	PARAFUSO FIX. CRIVO M5X12 Sieve screw M5X12
A11	>	7.0.001.0003	CHASSI CONJUNTO Chassi assembly	H19	>	5.0.000.0940	TUBO DE SILICONE 6MM Silicone tube 6mm
B01	>	4.0.000.0500	CAIXA ST1 110584 Box ST1 110584	H20	>	5.0.000.0041	BOMBA VIBRATÓRIA ULKA 220V Ulka pump 220V
B02	>	4.0.000.0512	INTERRUPTOR BIPOLAR E0014 Two pole switch E0014		>	5.0.000.0045	BOMBA VIBRATÓRIA ULKA 110V Ulka pump
B03	>	4.0.001.0075	PULSADOR UNIPOLAR E2009 Single pole button	H21	>	7.0.000.0777	SUPORTE DA BOMBA Pump support
B04	>	4.0.000.0504	CAIXA ST3 110586 Box ST3 110586	H22	>	5.0.000.0725	RACORD DIREITO Right raccord
B05	>	4.0.000.0508	TASTO VERMELHO/VERDE Switch box red/green	H23	>	5.0.000.0180	FILTRO ENTRADA DE ÁGUA Water inlet filter
B06	>	4.0.000.0506	TASTO T5 Switch box T5	H24	>	5.0.000.0100	DEPÓSITO ÁGUA Water Deposit
B07	>	5.0.000.0238	INTERRUPTOR Switch	I01	>	4.2.000.9253	BARRA DE LIGADORES 10 MM Connectors 10 mm
	>	5.0.000.0690	PULSADOR NÃO LUMINOSO Button without light	I02	>	7.0.000.0770	SONDA MINI BAR (180mm) Mini Bar probe (180mm)
	>	5.0.000.0691	PULSADOR LUMINOSO Button with light	I03	>	7.0.000.0773	SONDA MINI BAR (200mm) Mini Bar probe (200mm)
B08	>	4.0.000.0515	PULSADORES CM BIPOLARES Double pole button	I04	>	4.0.000.0463	DETECTOR DE NÍVEL LLD 1 230V Level Detector LLD 1 230V
C01	>	4.0.075.0070	CABO SECTOR H05 RN-F 3X1 Cable H05 RN-F 3X1		>	4.0.000.0460	DETECTOR DE NÍVEL LLD 1 120V Level Detector LLD 1 120V
C02	>	4.2.000.9457	SERRA CABOS PA 107 (ELE. MCF.CB) Cable fastener PA 107 (ELE. MCF.CB)	I05	>	4.0.001.0060	SINALIZADOR Led
D01	>	5.0.000.0660	PORTA FILTRO SIMPLES Simple filter holder	K01	>	4.0.000.0130	PORCA P/TUBO 6 MM 6mm tube nut
D02	>	5.0.000.0410	MOLA PORTA FILTRO Filter holder spring	K02	>	4.0.000.0067	BICONE P/TUBO 6 MM 6mm tube smashing nut
D03	>	5.0.000.0661	PORTA FILTRO CROMADO Chromated filter holder	L01	>	4.0.001.0015	COLHER Spoon
D04	>	4.0.025.0025	PUNHO PORTA FILTRO Handgrip for filter holder	L02	>	4.0.001.0010	CALCADOR Coffee tamper
D05	>	4.2.000.9058	PARAFUSO CAB. CIL. UMBRACO M8X20 Screw M8X20				
D06	>	4.0.025.0030	TAMPO PUNHO PORTA FILTRO Plug for handgrip				
E01	>	5.0.000.0170	FILTRO 1 BICA 6 GRS. 1 coffee filter 6 Gr				
E02	>	5.0.000.0173	FILTRO 2 BICAS 12 GRS. 2 coffees filter 12 Gr				
E03	>	5.0.000.0263	JUNTA COMPENSAÇÃO 57X66X0,8 Gasket 57x66x0,8				
	>	5.0.000.0264	JUNTA COMPENSAÇÃO ESTREITA 66 X 58 Gasket 66x58				
F01	>	5.0.000.0108	DISTRIBUIDOR 2 BICAS 2 Coffees outlet				
G01	>	5.0.000.0893	TORNEIRA ESC. CHÁVENAS Tap to warm cups				
G02	>	5.0.000.0906	TUBO CROMADO ÁGUA/VAPOR (Modelo Corrente) Water/steam tube (new model)				
G03	>	5.0.000.0908	TUBO ÁGUA / VAPOR CROMADO (Modelo Antigo) Water/steam tube (new model)				
G04	>	5.0.000.0645	PONTEIRA TUBO VAPOR End of the steam tube				
G05	>	5.0.000.0649	PORCA PLÁSTICA TORNEIRA Plastic nut for tap				
G06	>	4.0.025.0020	MANIPULO DA TORNEIRA Tap handle				
H01	>	5.0.000.0207	GRUPO MINI BAR Mini Bar group				
H02	>	5.0.000.0871	TERMOSTATO 261-107º Thermostat 261-107º				
H03	>	5.0.000.0872	TERMOSTATO 261-145º Thermostat 261-145º				
H04	>	5.0.000.0730	RACORD L 1/8-1/8 Raccord L 1/8-1/8				
H05	>	5.0.000.0874	TERMOSTATO 261-165º Thermostat				
H06	>	5.0.000.0880	TERMOSTATO (Modelo antigo) Thermostat (Old model)				
H07	>	5.0.000.0303	JUNTA RESISTÊNCIA Heating element gasket				
H08	>	5.0.000.0785	RESISTÊNCIA MINI-BAR 220V Mini Bar heating element 220V				
H09	>	5.0.000.0500	ORING CORPO GRUPO				



ESQUEMA ELETRICO Electric diagram

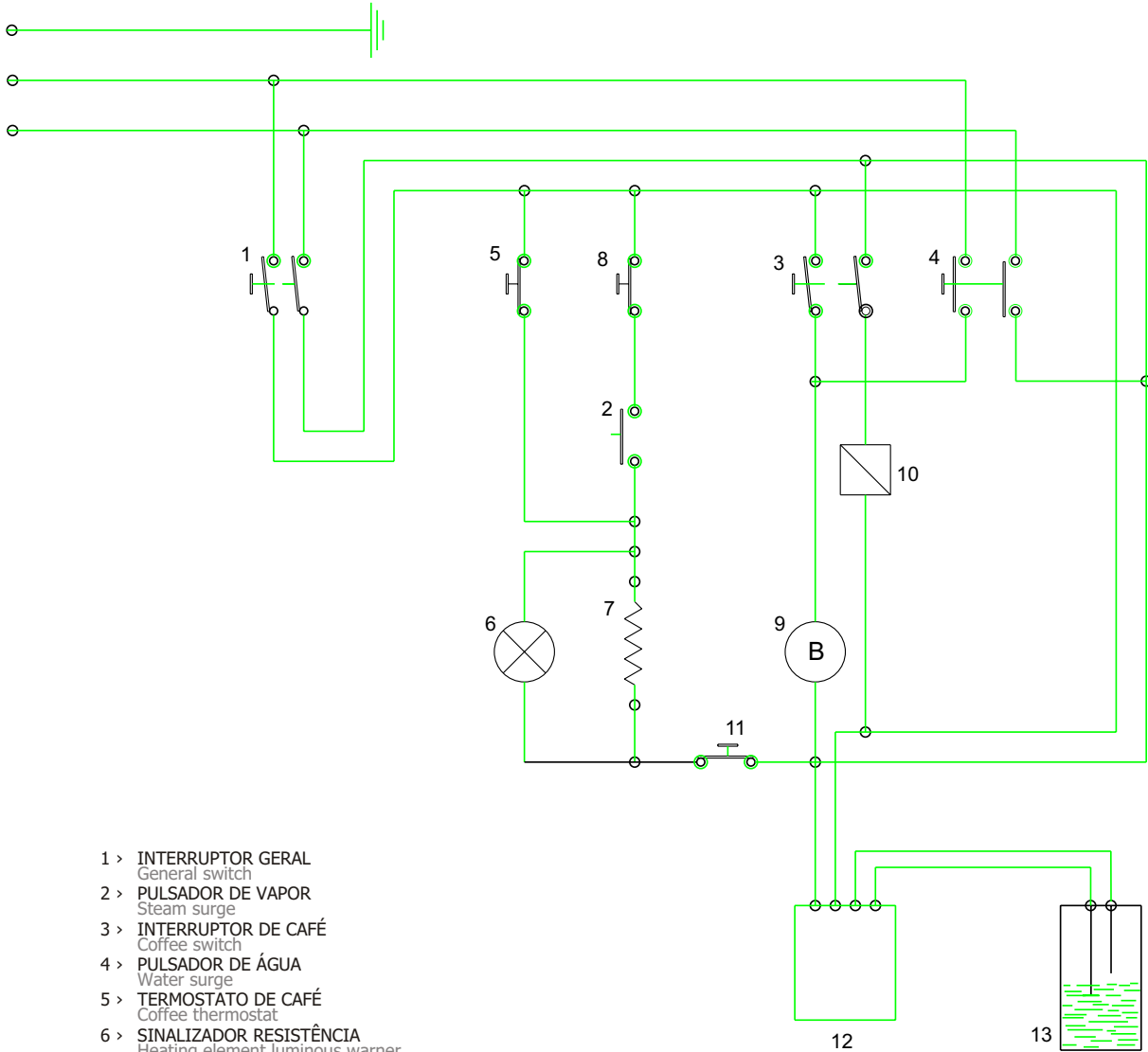

- 1 > INTERRUPTOR GERAL
General switch
- 2 > PULSADOR DE VAPOR
Steam surge
- 3 > INTERRUPTOR DE CAFÉ
Coffee switch
- 4 > PULSADOR DE ÁGUA
Water surge
- 5 > TERMOSTATO DE CAFÉ
Coffee thermostat
- 6 > SINALIZADOR RESISTÊNCIA
Heating element luminous warmer
- 7 > RESISTÊNCIA
Heating element
- 8 > TERMOSTATO DE VAPOR
Steam thermostat
- 9 > BOMBA
Pump
- 10 > ELECTROVÁLVULA DE CAFÉ
Coffee electrovalve
- 11 > TERMOSTATO DE SEGURANÇA
Safety thermostat
- 12 > DETECTOR DE NÍVEL
Level detector
- 13 > DEPÓSITO
Tank